

Flash Graphic Track Installation Guide

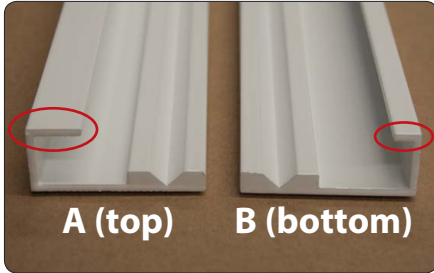

1. Ensure correct extrusion is used for the top and bottom. The top extrusion has a longer lip than the bottom extrusion (see above).



2. Place the bottom extrusion into desired position using a level. Mark the position with a pencil.

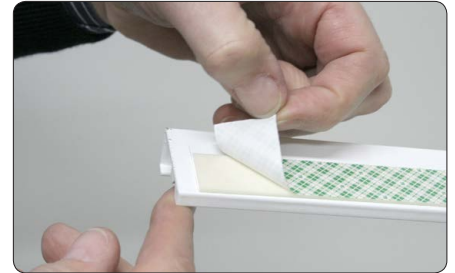

3. Peel off the backing from the double sided tape. Stick the bottom track into marked position. **Note: Both tracks must be installed using mechanical fixings.**



4. Secure the track with **countersunk** screws (use appropriate wall fixings). Screw head must be flush as not to interfere with the graphic panel.



5. Place the spacers into the bottom channel on either end of the bottom track. (see image for step 7).



6. Place the track on the top edge of the spacer. Ensure that the spacer fits tightly inside the channel. Check track is level. Mark position with pencil.



7. Peel the backing tape from the top track. Press the top track firmly into position, then secure with countersunk screws. Remove the spacers.



8. Install graphic panels by pushing the top edge of the graphic panel into the top channel.



9. Drop the bottom edge of the graphic into the bottom channel. Inset shows graphic panel sitting in bottom channel.



10. When the graphic panel sits in the bottom channel, The top 5mm of the graphic will be held by the top track.



Graphic Track with 3 graphic panels

check it out on the web: <https://www.youtube.com/watch?v=n-Cp7OpWKd4>

FREE CALL
1800 606 682
www.flash.com.au

Sydney
15 Chapel Street
Marrickville NSW 2204
T +61 2 8594 3555
E flash.aus@flash.com.au

Brisbane
19 Chester Street
Newstead Qld 4006
T +61 7 3620 7600
E brisbane.qld@flash.com.au

Canberra
61 Kembla Street
Fyshwick ACT 2609
T +61 2 6280 6166
E canberra.act@flash.com.au