

# Flash Graphic Track Installation Guide

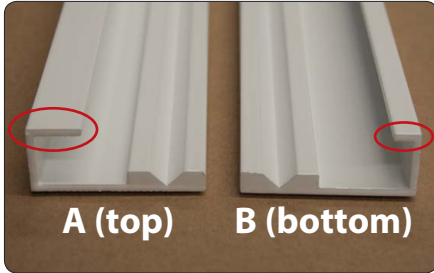

**1.** Ensure correct extrusion is used for the top and bottom. The top extrusion has a longer lip than the bottom extrusion (see above).



**2.** Place the bottom extrusion into desired position using a level. Mark the position with a pencil.

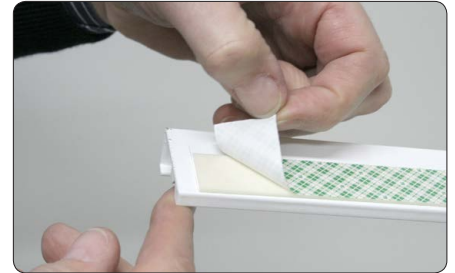

**3.** Peel off the backing from the double sided tape. Stick the bottom track into marked position. **Note: Both tracks must be installed using mechanical fixings.**



**4.** Secure the track with **countersunk** screws (use appropriate wall fixings). Screw head must be flush as not to interfere with the graphic panel.



**5.** Place the spacers into the bottom channel on either end of the bottom track. (see image for step 7).



**6.** Place the track on the top edge of the spacer. Ensure that the spacer fits tightly inside the channel. Check track is level. Mark position with pencil.



**7.** Peel the backing tape from the top track. Press the top track firmly into position, then secure with countersunk screws. Remove the spacers.



**8.** Install graphic panels by pushing the top edge of the graphic panel into the top channel.



**9.** Drop the bottom edge of the graphic into the bottom channel. Inset shows graphic panel sitting in bottom channel.



**10.** When the graphic panel sits in the bottom channel, The top 5mm of the graphic will be held by the top track.



Graphic Track with 3 graphic panels

check it out on the web: <https://www.youtube.com/watch?v=n-Cp7OpWKd4>

**FREE CALL**  
**1800 606 682**  
**www.flash.com.au**

**Sydney**  
15 Chapel Street  
Marrickville NSW 2204  
T +61 2 8594 3555  
E [flash.aus@flash.com.au](mailto:flash.aus@flash.com.au)

**Brisbane**  
23 Links Avenue North  
Eagle Farm Qld 4009  
T +61 7 3620 7600  
E [brisbane.qld@flash.com.au](mailto:brisbane.qld@flash.com.au)

**Canberra**  
61 Kembla Street  
Fyshwick ACT 2609  
T +61 2 6280 6166  
E [canberra.act@flash.com.au](mailto:canberra.act@flash.com.au)